

| REV. | ECN NO. | LOCAS. | DESCRIPTION         | DATE | DESIGN |
|------|---------|--------|---------------------|------|--------|
| A0   |         |        | RELEASE TO CUSTOMER |      | HANG   |
| B    |         |        |                     |      | HANG   |

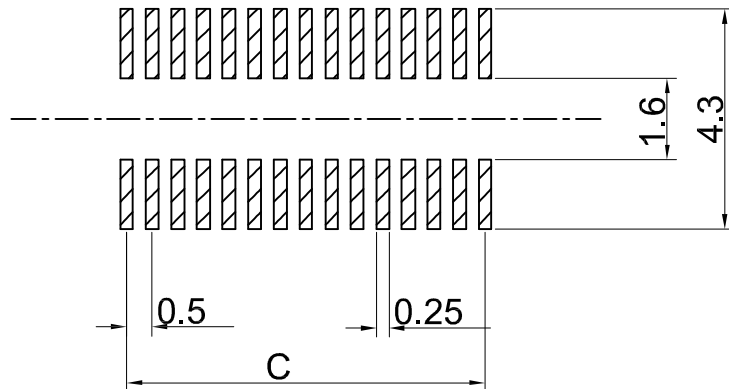
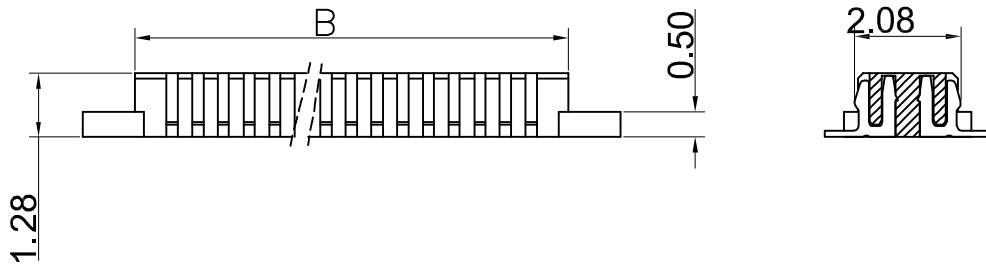
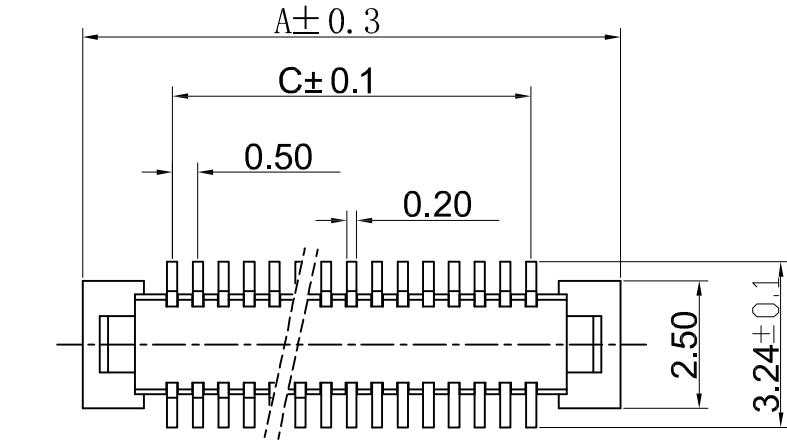

PCB LAYOUT

| PIN | A     | B     | C     | PIN | A     | B     | C     |
|-----|-------|-------|-------|-----|-------|-------|-------|
| 004 | 5.00  | 2.90  | 1.50  | 033 | 19.50 | 17.40 | 16.00 |
| 005 | 5.50  | 3.40  | 2.00  | 034 | 20.00 | 17.90 | 16.50 |
| 006 | 6.00  | 3.90  | 2.50  | 035 | 20.50 | 18.40 | 17.00 |
| 007 | 6.50  | 4.40  | 3.00  | 036 | 21.00 | 18.90 | 17.50 |
| 008 | 7.00  | 4.90  | 3.50  | 037 | 21.50 | 19.40 | 18.00 |
| 009 | 7.50  | 5.40  | 4.00  | 038 | 22.00 | 19.90 | 18.50 |
| 010 | 8.00  | 5.90  | 4.50  | 039 | 22.50 | 20.40 | 19.00 |
| 011 | 8.50  | 6.40  | 5.00  | 040 | 23.00 | 20.90 | 19.50 |
| 012 | 9.00  | 6.90  | 5.50  | 041 | 23.50 | 21.40 | 20.00 |
| 013 | 9.50  | 7.40  | 6.00  | 042 | 24.00 | 21.90 | 20.50 |
| 014 | 10.00 | 7.90  | 6.50  | 043 | 24.50 | 22.40 | 21.00 |
| 015 | 10.50 | 8.40  | 7.00  | 044 | 25.00 | 22.90 | 21.50 |
| 016 | 11.00 | 8.90  | 7.50  | 045 | 25.50 | 23.40 | 22.00 |
| 017 | 11.50 | 9.40  | 8.00  | 046 | 26.00 | 23.90 | 22.50 |
| 018 | 12.00 | 9.90  | 8.50  | 047 | 26.50 | 24.40 | 23.00 |
| 019 | 12.50 | 10.40 | 9.00  | 048 | 27.00 | 24.90 | 23.50 |
| 020 | 13.00 | 10.90 | 9.50  | 049 | 27.50 | 25.40 | 24.00 |
| 021 | 13.50 | 11.40 | 10.00 | 050 | 28.00 | 25.90 | 24.50 |
| 022 | 14.00 | 11.90 | 10.50 | 051 | 28.50 | 26.40 | 25.00 |
| 023 | 14.50 | 12.40 | 11.00 | 052 | 29.00 | 26.90 | 25.50 |
| 024 | 15.00 | 12.90 | 11.50 | 053 | 29.50 | 27.40 | 26.00 |
| 025 | 15.50 | 13.40 | 12.00 | 054 | 30.00 | 27.90 | 26.50 |
| 026 | 16.00 | 13.90 | 12.50 | 055 | 30.50 | 28.40 | 27.00 |
| 027 | 16.50 | 14.40 | 13.00 |     |       |       |       |
| 028 | 17.00 | 14.90 | 13.50 |     |       |       |       |
| 029 | 17.50 | 15.40 | 14.00 |     |       |       |       |
| 030 | 18.00 | 15.90 | 14.50 |     |       |       |       |
| 031 | 18.50 | 16.40 | 15.00 |     |       |       |       |
| 032 | 19.00 | 16.90 | 15.50 |     |       |       |       |

| DIM   | TOL        | DIM    | TOL        |
|-------|------------|--------|------------|
| X.    | $\pm 0.30$ | X'.    | $\pm 4.0'$ |
| X.X   | $\pm 0.25$ | X.X'   | $\pm 3.0'$ |
| X.XX  | $\pm 0.20$ | X.XX'  | $\pm 2.0'$ |
| X.XXX | $\pm 0.10$ | X.XXX' | $\pm 1.0'$ |

THIS DRAWING CONTAINS INFORMATION THAT IS PROVIDED BY LASTAR TECHNOLOGY AND SHOULD NOT BE USED WITHOUT WRITTEN PERMISSION

# LASTAR

Lastar Technology CO., LTD

|          |        |        |   |            |
|----------|--------|--------|---|------------|
| DRAW NO. |        | DATE   | DRAW NAME:                                    |            |
| DESIGN   | HANG   | 080805 | 0.5mm Pitch Board To Board Plug 合高1.5H-2.5H无柱 |            |
| CHECK    | WANGCM | 080806 | P/N NO.                                       | FILE:      |
| APPROVED | HUYX   | 080806 | BTB-051-001-XX01-13                           | MODEL:     |
|          |        |        | UNIT: mm                                      | SHEET: N/A |
|          |        |        | REV. B  | SCALE N/A  |