

**\*所有原料材质，生产制程，电镀必须符合RoHS要求\***

REV.	ECN NO.	LOCAS.	DESCRIPTION	DATE	DESIGN
A			RELEASE TO CUSTOMER	150116	YINC
B			增加PIN脚定义	221116	YINC

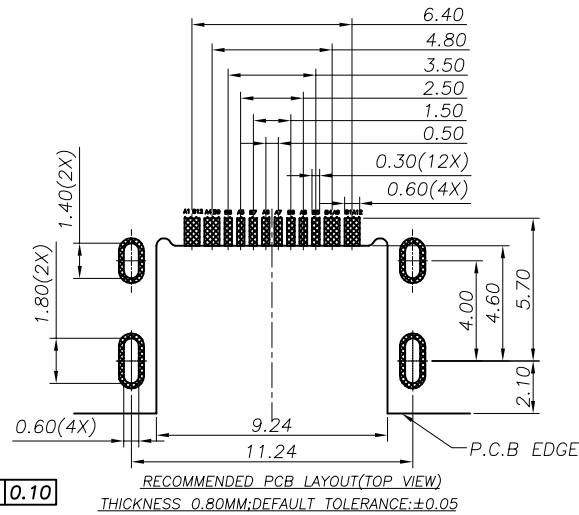
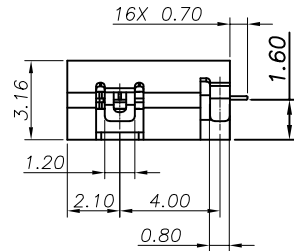
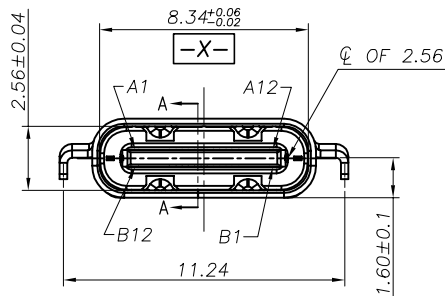
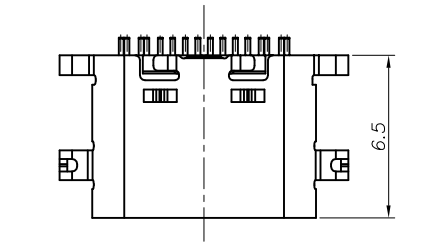

USB TYPE-C PIN ASSIGNMENTS

PIN NUMBER	SIGNAL NAME	PIN NUMBER	SIGNAL NAME
A1	GND	B12	GND
A4	VBUS	B9	VBUS
A5	CC1	B8	SBU2
A6	Dp1	B7	Dn2
A7	Dn1	B6	Dp2
A8	SBU1	B5	CC2
A9	VBUS	B4	VBUS
A12	GND	B1	GND

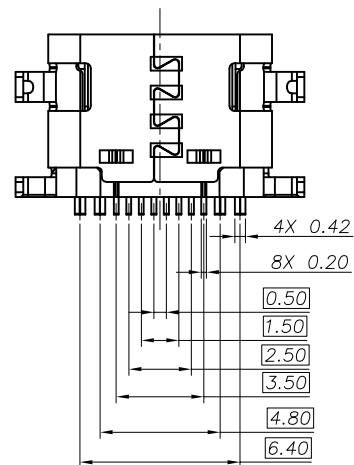
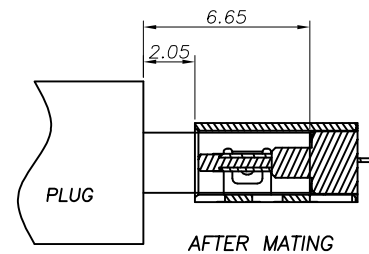
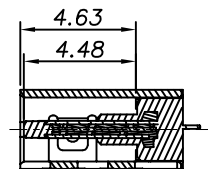
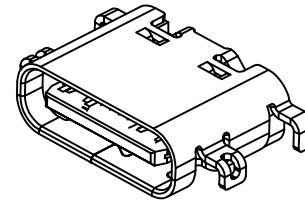

备注:

1.材质及电镀: 见附表1

2.电气性能:

2.1 接触电阻: 30mΩ Max FOR INITIAL.  
40mΩ Max AFTER TEST.

2.2 耐电压:100V AC

2.3 绝缘:100MΩ Min

2.4 额定电流:

COLLECTIVELY VBUS PIN (A4,A9,B4,B9) ,TOTAL 5A  
VCCON PIN (B5) THROUGH GND PIN(A1,A12,B1,B12)  
,1.25A OTHERS PIN, 0.25A

2.5 工作温度: -40°C ~ 80°C.

3.机械性能:

3.1 插入力: 5~20N.

3.2 拔出力: 初始值8~20N测试后6~20N

3.3 寿命: 10,000 CYCLES

07	外壳	不锈钢	1	SUS 304 1/2H,T0.30
06	二次Molding件	LCP	1	黑色 UL94 V-0
05	上排MD件	LCP	1	黑色 UL94 V-0
04	下排MD件	LCP	1	黑色 UL94 V-0
03	中夹片	SUS301-H T=0.15	1	不电镀
01	端子	C2680-H T=0.15	1set	功能接触区镀金, 焊脚镀金
序号	品名	材质	用量	备注

DIM	TOL	DIM	TOL
X.	±0.30	X".	±4.0"
X.X	±0.25	X.X"	±3.0"
X.XX	±0.20	X.XX"	±2.0"
X.XXX	±0.10	X.XXX"	±1.0"

THIS DRAWING CONTAINS INFORMATION THAT IS PROVIDED BY LASTAR TECHNOLOGY AND SHOULD NOT BE USED WITHOUT WRITTEN PERMISSION

DRAW NO.	DATE
DESIGN	YINC
CHECK	ZHAOZZ
APPROVED	HUXW

**LSDconn**®  
Http://www.lsdconn.com

**WT**®  
Http://www.asia-wt.com

■深圳朗思达 □香港朗思达  
□东莞共营 □前海共赢

**connector & cable**

DRAW NAME:	
TYPE C 母座 16PIN 单排 沉板 1.6 四脚插板 L6.5	
P/N NO.	21000173
UNIT:	mm
SHEET:	N/A
MODEL	REV. B
SCALE	N/A