

LHV 系列



产品特点

- 高温无铅回流焊产品
- 保证时间：125°C 5000 小时
- 高频低阻品适用于高温用途
- 符合 RoHS 标准

| 项目 | 特性 | | | | | | | | | |
|-----------------------------|---|--------------|------|------|------|------|------|------|------|---|
| 工作温度范围 | -55°C ~ +125°C | | | | | | | | | |
| 额定电压范围 | 10V ~ 100V | | | | | | | | | |
| 静电容量范围 | 22 ~ 4700 μF | | | | | | | | | |
| 静电容量允许偏差 | ±20% (20°C, 120Hz) | | | | | | | | | |
| 漏电流 | (μA), 取较大者 (2 分钟) CR: 标称容量 (μF) UR: 额定电压 (V) | | | | | | | | | |
| 损耗角正切 (tg δ) 20°C, 120Hz | U _R (V) | 10 | 16 | 25 | 35 | 50 | 63 | 80 | 100 | |
| | tg δ | 0.24 | 0.20 | 0.16 | 0.14 | 0.14 | 0.12 | 0.12 | 0.10 | |
| 耐久性 | +125°C 施加额定电压 5000 小时后, 电容器应满足以下要求: ΦD=8, 10, 12.5, 16, 18 为 5000 小时 | | | | | | | | | |
| | 电容量变化率 | ±30% 初始值以内 | | | | | | | | |
| | 损耗角正切 | ≤ 300% 初始规定值 | | | | | | | | |
| | 漏电流 | ≤ 初始规定值 | | | | | | | | |
| 高温贮存 | +125°C 贮存 1000 小时后, 电容器应满足以上耐久性要求 | | | | | | | | | |
| 低温特性 | U _R (V) | 10 | 16 | 25 | 35 | 50 | 63 | 80 | 100 | |
| | Z(-25°C)/Z(+20°C) | 3 | 3 | 2 | 2 | 2 | 2 | 2 | 2 | 2 |
| | Z(-55°C)/Z(+20°C) | 8 | 6 | 4 | 4 | 4 | 3 | 3 | 3 | 3 |
| 耐焊接热 | 在 250°C 的条件下, 电容器在热板上保持 30 秒, 然后从热板上取出电容器, 让其在室温下恢复, 电容器应满足以下要求 | | | | | | | | | |
| | 电容量变化率 | ±10% 初始值以内 | | | | | | | | |
| | 损耗角正切 (tg δ) | ≤ 初始规定值 | | | | | | | | |
| | 漏电流 | ≤ 初始规定值 | | | | | | | | |

纹波电流频率系数

| 尺寸 | Cap. (uF) | 120HZ | 1K | 10K | 100K |
|-----------|-----------|-------|------|------|------|
| D8~D10 | 10 | 0.66 | 0.86 | 0.96 | 1 |
| | 220~470 | 0.93 | 0.97 | 1 | 1 |
| D12.5~D18 | 47~100 | 0.4 | 0.75 | 0.9 | 1 |
| | 220~470 | 0.5 | 0.85 | 0.94 | 1 |
| | 680~1000 | 0.6 | 0.87 | 0.95 | 1 |
| | 2200~3300 | 0.75 | 0.9 | 0.95 | 1 |
| | 4700 | 0.85 | 0.95 | 0.98 | 1 |

标 示

例: 35V 470uF LHV 系列

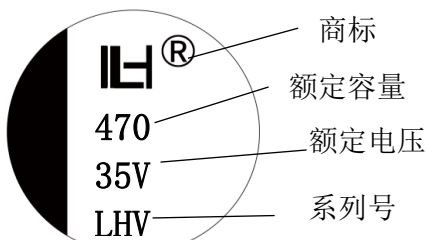

外观尺寸

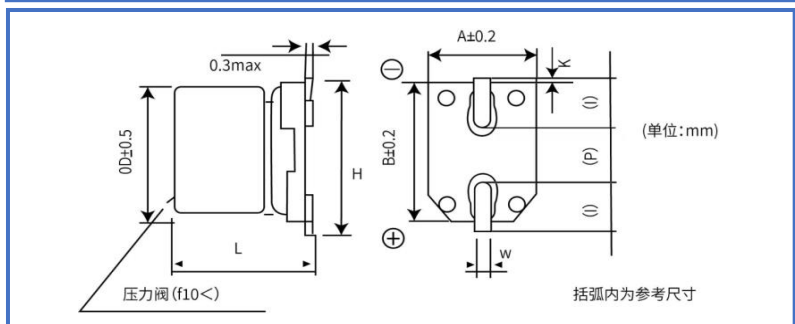

| φ D | L | A, B | H. | I | W | P | K |
|------|----------|------|------|-----|---------|-----|-----------|
| 8 | 10.5±0.5 | 8.3 | 9.0 | 3.4 | 0.8~1.1 | 3.1 | 0.70±0.20 |
| | 12.5±0.5 | | | | | | |
| 10 | 10.5±0.5 | 10.3 | 11.0 | 3.5 | | 4.5 | |
| | 12.5±0.5 | | | | | | |
| 12.5 | 13.5±0.5 | 13.5 | 13.7 | 4.7 | 4.4 | | |
| | 16.5±0.5 | | | | | | |
| 16 | 16.5±0.5 | 17 | 18.0 | 5.5 | 1.1~1.4 | 6.4 | |
| | 21.5±0.5 | | | | | | |
| 18 | 16.5±0.5 | 19 | 20.0 | 6.7 | | | |
| | 21.5±0.5 | | | | | | |

特性一览表 1

| 额定电压 (V. DC) | 静电容量 (±20%) (uF) | 产品尺寸(mm) | | 电气特性 | | | 料号 | 最小包装 数量 (PCS) |
|-----------------|------------------------|----------|------|---|-------------------------|-------------------------------------|--------------------|---------------------|
| | | φ D | L | 额定纹波电流 (100KHZ/+125℃) (mA r. m. s) | tan δ (120HZ) (+20℃) | Impedance (100KHZ) (+20℃) (Ω) | | |
| 10 | 220 | 8 | 10.5 | 220 | 0.24 | 0.40 | LHV1A221MF10500LP0 | 500 |
| | 330 | 10 | 10.5 | 296 | 0.24 | 0.30 | LHV1A331MG10500LP0 | 500 |
| | 470 | 10 | 12.5 | 310 | 0.24 | 0.28 | LHV1A471MG12500LP0 | 500 |
| | 470 | 12.5 | 13.5 | 750 | 0.24 | 0.14 | LHV1A471MI13500LP0 | 200 |
| | 680 | 12.5 | 13.5 | 750 | 0.24 | 0.14 | LHV1A681MI13500LP0 | 200 |
| | 1000 | 12.5 | 13.5 | 750 | 0.24 | 0.14 | LHV1A102MI13500LP0 | 200 |
| | 2200 | 16 | 16.5 | 1000 | 0.26 | 0.10 | LHV1A222MJ16500LP0 | 125 |
| | 3300 | 18 | 16.5 | 1200 | 0.28 | 0.10 | LHV1A332MK16500LP0 | 125 |
| | 4700 | 18 | 21.5 | 1500 | 0.30 | 0.058 | LHV1A472MK21500LP0 | 75 |
| 16 | 100 | 8 | 10.5 | 220 | 0.20 | 0.40 | LHV1C101MF10500LP0 | 500 |
| | 220 | 10 | 10.5 | 296 | 0.20 | 0.30 | LHV1C221MG10500LP0 | 500 |
| | 330 | 10 | 10.5 | 296 | 0.20 | 0.30 | LHV1C331MG10500LP0 | 500 |
| | 470 | 12.5 | 13.5 | 750 | 0.20 | 0.14 | LHV1C471MI13500LP0 | 200 |
| | 680 | 12.5 | 13.5 | 750 | 0.20 | 0.14 | LHV1C681MI13500LP0 | 200 |
| | 1000 | 18 | 16.5 | 1200 | 0.20 | 0.10 | LHV1C102MK16500LP0 | 125 |
| | 2200 | 18 | 16.5 | 1200 | 0.22 | 0.10 | LHV1C222MK16500LP0 | 125 |
| | 4700 | 18 | 21.5 | 1500 | 0.24 | 0.058 | LHV1C472MK21500LP0 | 75 |
| 25 | 100 | 8 | 10.5 | 220 | 0.16 | 0.40 | LHV1E101MF10500LP0 | 500 |
| | 220 | 10 | 10.5 | 296 | 0.16 | 0.30 | LHV1E221MG10500LP0 | 500 |
| | 330 | 12.5 | 13.5 | 750 | 0.16 | 0.14 | LHV1E331MI13500LP0 | 200 |
| | 470 | 12.5 | 13.5 | 750 | 0.16 | 0.14 | LHV1E471MI13500LP0 | 200 |
| | 680 | 16 | 16.5 | 1000 | 0.16 | 0.10 | LHV1E681MJ16500LP0 | 125 |
| | 1000 | 18 | 21.5 | 1500 | 0.16 | 0.058 | LHV1E102MK21500LP0 | 75 |
| | 4700 | 18 | 21.5 | 1500 | 0.18 | 0.058 | LHV1E472MK21500LP0 | 75 |
| 35 | 100 | 10 | 10.5 | 296 | 0.14 | 0.30 | LHV1V101MG10500LP0 | 500 |
| | 220 | 10 | 10.5 | 296 | 0.14 | 0.30 | LHV1V221MG10500LP0 | 500 |
| | 330 | 12.5 | 13.5 | 750 | 0.14 | 0.14 | LHV1V331MI13500LP0 | 200 |
| | 470 | 12.5 | 13.5 | 750 | 0.14 | 0.14 | LHV1V471MI13500LP0 | 200 |
| | 680 | 18 | 16.5 | 1200 | 0.14 | 0.10 | LHV1V681MK16500LP0 | 125 |
| 50 | 100 | 10 | 10.5 | 247 | 0.14 | 0.50 | LHV1H101MG10500LP0 | 500 |
| | 220 | 12.5 | 13.5 | 550 | 0.14 | 0.23 | LHV1H221MI13500LP0 | 200 |

特性一览表 2

| 额定电压 (V. DC) | 静电容量 (±20%) (uF) | 产品尺寸(mm) | | 电气特性 | | | 料号 | 最小包装 数量 (PCS) |
|-----------------|------------------------|----------|------|--|------------------------|-------------------------------------|--------------------|---------------------|
| | | φ D | L | 额定纹波电流 (100KHZ/+125℃) (mA r. m. s) | tan δ (120H) (+20℃) | Impedance (100KHZ) (+20℃) (Ω) | | |
| 50 | 330 | 16 | 16.5 | 850 | 0.14 | 0.15 | LHV1H331MJ16500LP0 | 125 |
| | 470 | 18 | 16.5 | 920 | 0.14 | 0.15 | LHV1H471MK16500LP0 | 125 |
| 63 | 22 | 8 | 10.5 | 100 | 0.12 | 0.70 | LHV1J220MF10500LP0 | 500 |
| | 33 | 8 | 10.5 | 100 | 0.12 | 0.70 | LHV1J330MF10500LP0 | 500 |
| | 47 | 8 | 10.5 | 100 | 0.12 | 0.70 | LHV1J470MF10500LP0 | 500 |
| | 100 | 12.5 | 13.5 | 500 | 0.12 | 0.25 | LHV1J101MI13500LP0 | 200 |
| | 220 | 12.5 | 16.5 | 600 | 0.12 | 0.20 | LHV1J221MI16500LP0 | 150 |
| 80 | 22 | 8 | 10.5 | 70 | 0.12 | 0.75 | LHV1K220MF10500LP0 | 500 |
| | 33 | 10 | 10.5 | 115 | 0.12 | 0.60 | LHV1K330MG10500LP0 | 500 |
| | 47 | 10 | 10.5 | 115 | 0.12 | 0.60 | LHV1K470MG10500LP0 | 500 |
| 100 | 22 | 10 | 10.5 | 115 | 0.10 | 0.60 | LHV2A220MG10500LP0 | 500 |
| | 33 | 10 | 10.5 | 115 | 0.10 | 0.60 | LHV2A330MG10500LP0 | 500 |
| | 47 | 12.5 | 13.5 | 450 | 0.10 | 0.35 | LHV2A470MI13500LP0 | 200 |