

GJS-2513HB-XXx2
Color: Natural

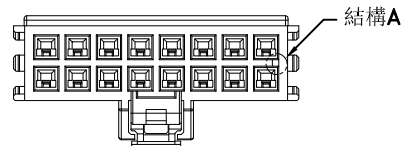

GJS-2513HA-XXx2
Color: Black

■ SPECIFICATIONS

- Voltage Rating : 250V AC/DC
- Current Rating : 8A AC/DC
- Withstanding Voltage : 1,500V AC/minute
- Insulation Resistance : 1,000MΩ min
- Temperature Range : - 40°C to + 105°C
- Contact Resistance : 30mΩ max.

■ HOUSING

- Part No. : GJS-2513HX-XXx2

① ②

① Structure :

A : 結構A, Color: Black

B : 結構B, Color: Natural

② Poles : 02x2~08x2

- Material : PA4T UL94V-0

- Use With: GJS-2513H-TPXX Terminal

- Use With: GJS-2513H-XXCV CAP(鎖定片)

- Use With: GJS-2513X&2513RX-XXx2 Wafer

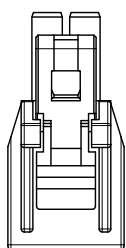
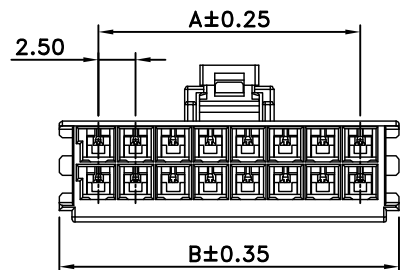

02x2P

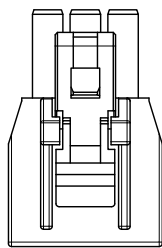

03x2P

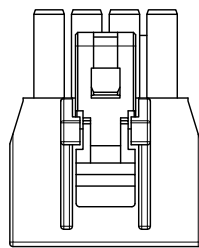

04x2P

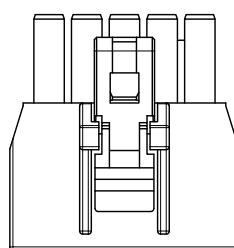

05x2P

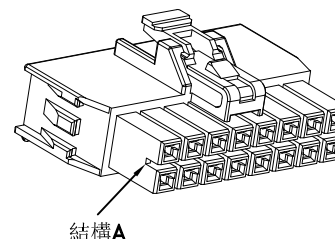

結構A

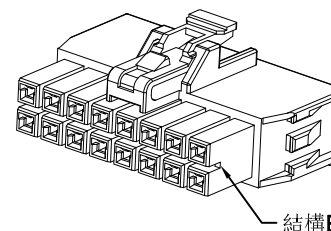

結構B

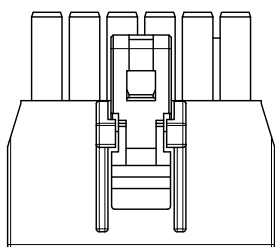

06x2P

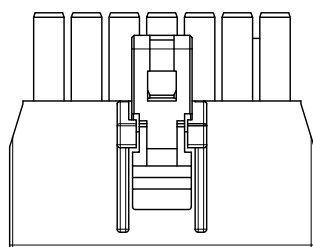

07x2P

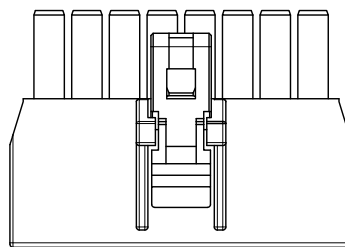

08x2P

Poles	Dimensions (mm)	
	A	B
02x2	2.50	7.70
03x2	5.00	10.20
04x2	7.50	12.70
05x2	10.00	15.20
06x2	12.50	17.70
07x2	15.00	20.20
08x2	17.50	22.70



东莞乔唯电子有限公司
DONGGUAN CHYAO WEI
ELECTRONIC CO., LTD

APPROVED BY	SCALE	UNIT	TOLERANCE	LTR	REVISION RECORD	NAME	DATE	LTR	REVISION RECORD	NAME	DATE
張育瑞		mm	.0 ±0.30	▲				▲			
CHECKED BY	PROJ	VER NO.	.00 ±0.20	▲				▲			
曾慶根	☉	α0	.000 ±0.10	▲				▲			
DRAWN BY	DATE	SIZE	ANGLE	▲				▲			
曾慶根	2020/11/16	A4	0° ±1°	▲				▲			
			.0° ±	▲				▲			
			SHEET 1/1	▲				▲			

CUSTOMER
Conforms to The RoHS Instruction

PART NO GJS-2513HX-XXx2

2.50mm Wire to Board Connectors Housing

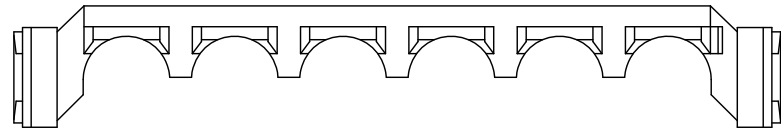
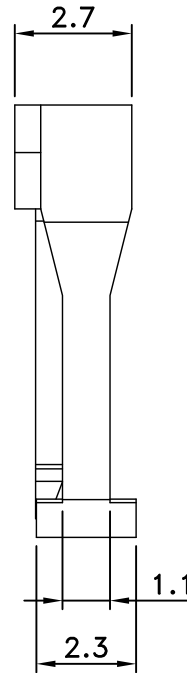
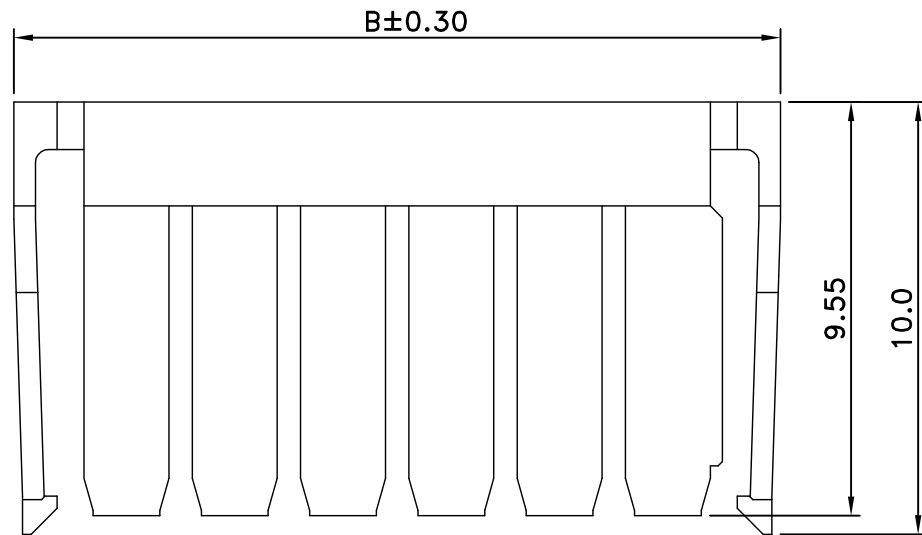
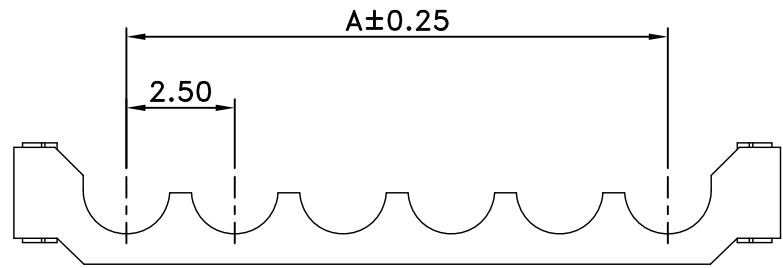

■ SPECIFICATIONS

- Voltage Rating : 250V AC/DC
- Current Rating : 8A AC/DC
- Withstanding Voltage : 1,500V AC/minute
- Insulation Resistance : 1,000MΩ min
- Temperature Range : - 40°C to + 105°C
- Contact Resistance : 30mΩ max.

■ CAP

- Part No. : GJS-2513H-XX XX CV

① ②

① Poles : 02-08

② Color :

Blank : Natural (配GJS-2513SHB&2513HB-XX)

BK : Black (配GJS-2513SHA&2513HA-XX)

• Material : PA 4T UL94V-0

• Use With: GJS-2513SHX & 2513HX-XX Housing

Poles	Dimensions (mm)	
	A	B
02	2.50	7.70
03	5.00	10.20
04	7.50	12.70
05	10.00	15.20
06	12.50	17.70
07	15.00	20.20
08	17.50	22.70



东莞乔唯电子有限公司
DONGGUAN CHYAO WEI
ELECTRONIC CO., LTD

APPROVED BY	SCALE	UNIT	TOLERANCE	LTR	REVISION RECORD	NAME	DATE	LTR	REVISION RECORD	NAME	DATE
張育瑞		mm	.0 ±0.30	△				△			
CHECKED BY	PROJ	VER NO.	.00 ±0.20	△				△			
曾慶根	⊕	a0	.000 ±0.10	△				△			
DRAWN BY	DATE	SIZE	ANGLE	△					CUSTOMER		
曾慶根	2020/11/16	A4	0° ±1°	△					Conforms to The RoHS Instruction		
			.0° ±	△							
			SHEET 1/1	△							

PART NO GJS-2513H-XXXXCV
2.50 mm Single Row CAP

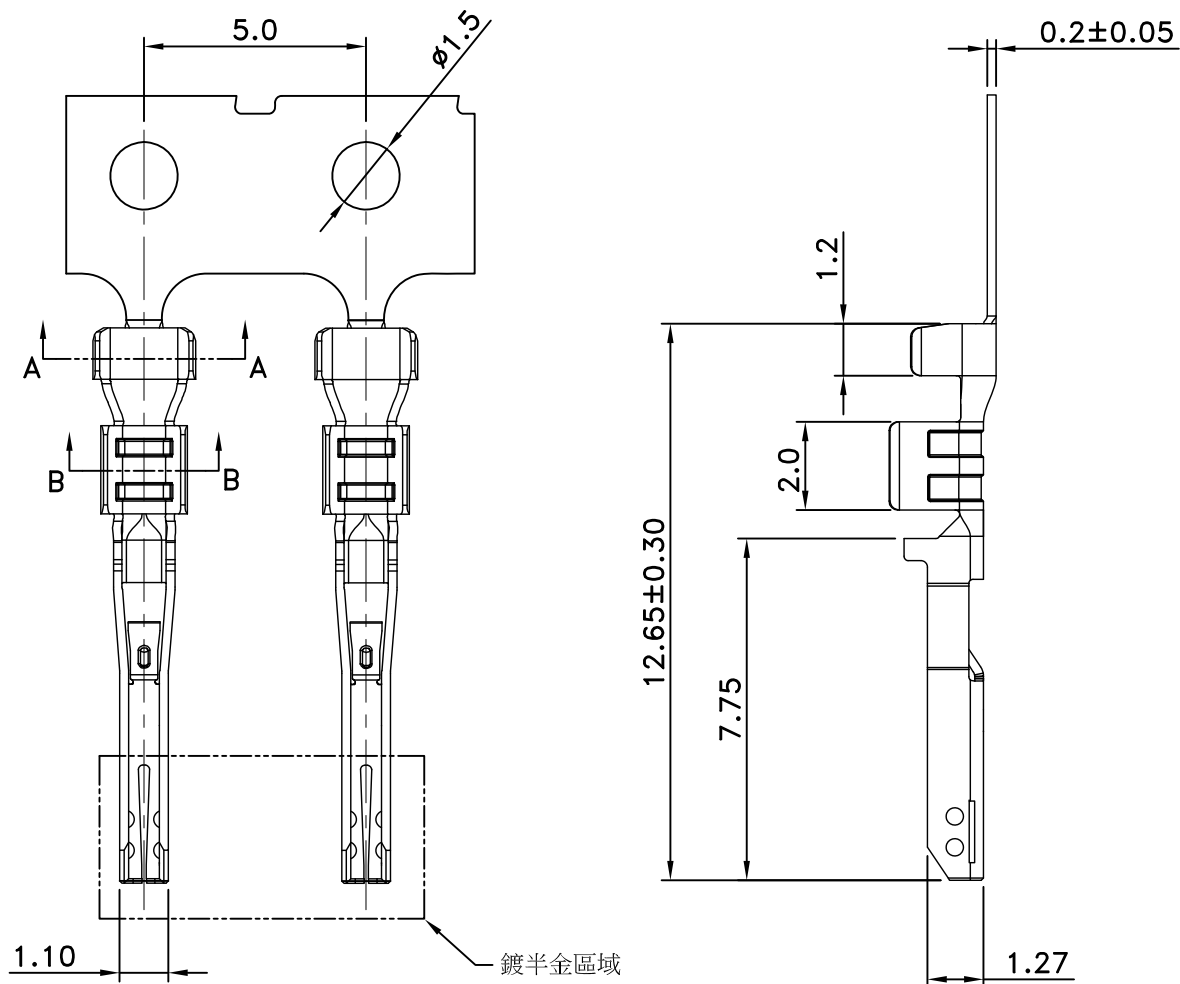

- SPECIFICATIONS
- Voltage Rating : 250V AC/DC
 - Current Rating : 8A AC/DC
 - Withstanding Voltage : 1,500V AC/minute
 - Insulation Resistance : 1,000MΩ min
 - Temperature Range : - 40°C to + 105°C
 - Contact Resistance : 30mΩ max.

- TERMINAL
- Part No. : GJS-2513H-TP XX (XX)
 - ① ② ③
 - ① TP : 先沖后鍍
 - ② Structure :
 - Blank : 低腳 (Applicable Wires : AWG 24#-26#)
 - H : 高腳 (Applicable Wires : AWG 20#-22#)
 - ③ Plated :
 - Blank : Tin-Plated
 - SG : Gold Flash (鍍半金 1u")
 - Material : High conductivity copper alloy
 - Q' ty : 10,000 Pcs./Reel
 - Use With: GJS-2513HX & 2513SHX-XX Housing

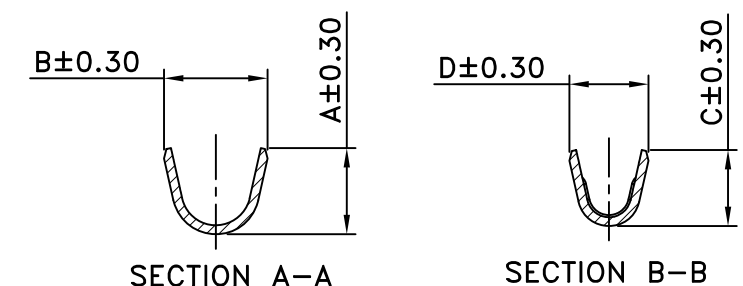

P/N	Dimensions (mm)			
	A	B	C	D
GJS-2513H-TPXX (低腳)	2.00	2.15	1.45	1.40
GJS-2513H-TPHX (高腳)	1.95	2.35	2.15	2.00

DGCW 东莞乔唯电子有限公司
DONGGUAN CHYAO WEI
ELECTRONIC CO., LTD

APPROVED BY	SCALE	UNIT	TOLERANCE	LTR	REVISION RECORD	NAME	DATE	LTR	REVISION RECORD	NAME	DATE
張育瑞		mm	.0 ±0.30	▲				▲			
CHECKED BY	PROJ	VER NO.	.00 ±0.20	▲				▲			
曾慶根	⊕ □	a0	.000 ±0.10	▲				▲			
DRAWN BY	DATE	SIZE	ANGLE	▲				▲			
曾慶根	2020/11/16	A4	0° ±1°	▲				▲			
			.0° ±	▲				▲			
			SHEET 1/1	▲				▲			

PART NO GJS-2513H-TPXX(XX)
2.50mm Wire to Board Connectors TERMINAL

CUSTOMER
Conforms to The RoHS Instruction

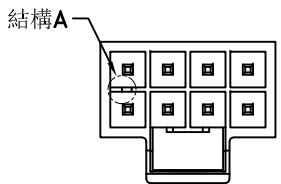
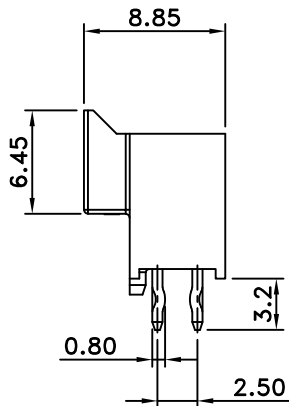
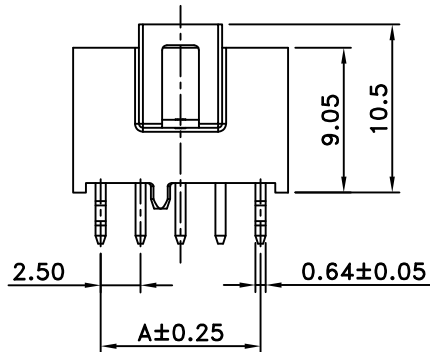
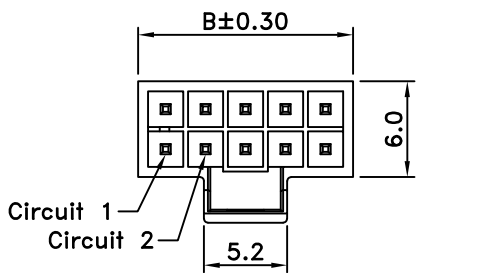

GJS-2513A-XXx2
Colour: Black

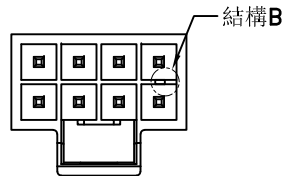

GJS-2513B-XXx2
Colour: Natural

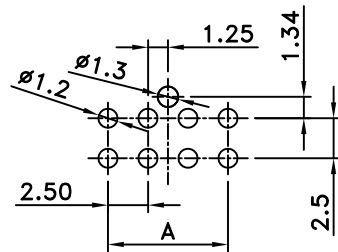

Recommended PCB Layout
(04 & 08 & 12 & 16)
General Tolerance ±0.05

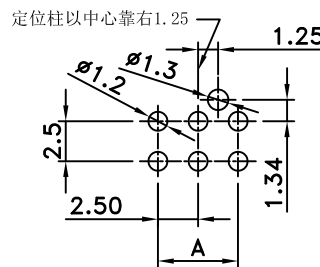

Recommended PCB Layout
(06 & 10 & 14)
General Tolerance ±0.05

■ SPECIFICATIONS

- Voltage Rating : 250V AC/DC
- Current Rating : 4A AC/DC
- Withstanding Voltage : 1,500V AC/minute
- Insulation Resistance : 1,000MΩ min
- Temperature Range : - 40°C to + 105°C
- Contact Resistance : 30mΩ max.

■ WAFER

- Part No. : GJS-2513X-XXx2

① ②

① Structure :

- A : 結構A, Colour: Black
- B : 結構B, Colour: Natural

② Poles : 02x2~08x2

• Material :

- Base : LCP UL94V-0
- Contact : Brass, Tin Plated
- Use With: GJS-2513HX-XXx2 Housing

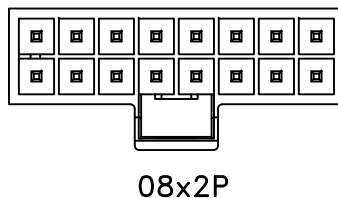
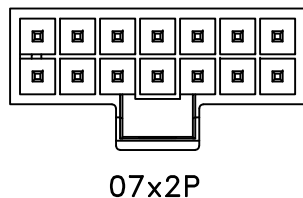
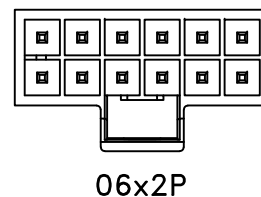
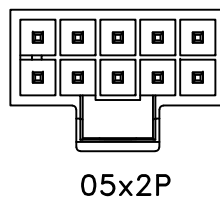
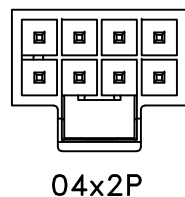
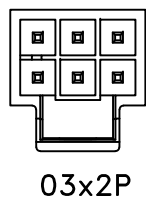
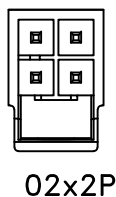

Poles	Dimensions (mm)	
	A	B
02x2	2.50	5.94
03x2	5.00	8.44
04x2	7.50	10.94
05x2	10.00	13.44
06x2	12.50	15.94
07x2	15.00	18.44
08x2	17.50	20.94



东莞乔唯电子有限公司
DONGGUAN CHYAO WEI
ELECTRONIC CO., LTD

APPROVED BY	SCALE	UNIT	TOLERANCE	LTR	REVISION RECORD	NAME	DATE	LTR	REVISION RECORD	NAME	DATE
張育瑞		mm	.0 ±0.30	△				△			
CHECKED BY	PROJ	VER NO.	.00 ±0.20	△				△			
曾庆根		α0	.000 ±0.10	△				△			
			ANGLE	△							
			0° ±1°	△							
			.0° ±	△							
			SHEET 1/1	△							
DRAWN BY									CUSTOMER		
曾庆根									Conforms to The RoHS Instruction		
DATE											
2020/11/16											
SIZE											
A4											

PART NO GJS-2513X-XXx2

2.50mm Wire to Board Connectors Wafer

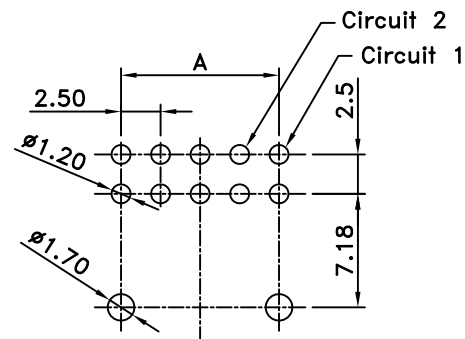
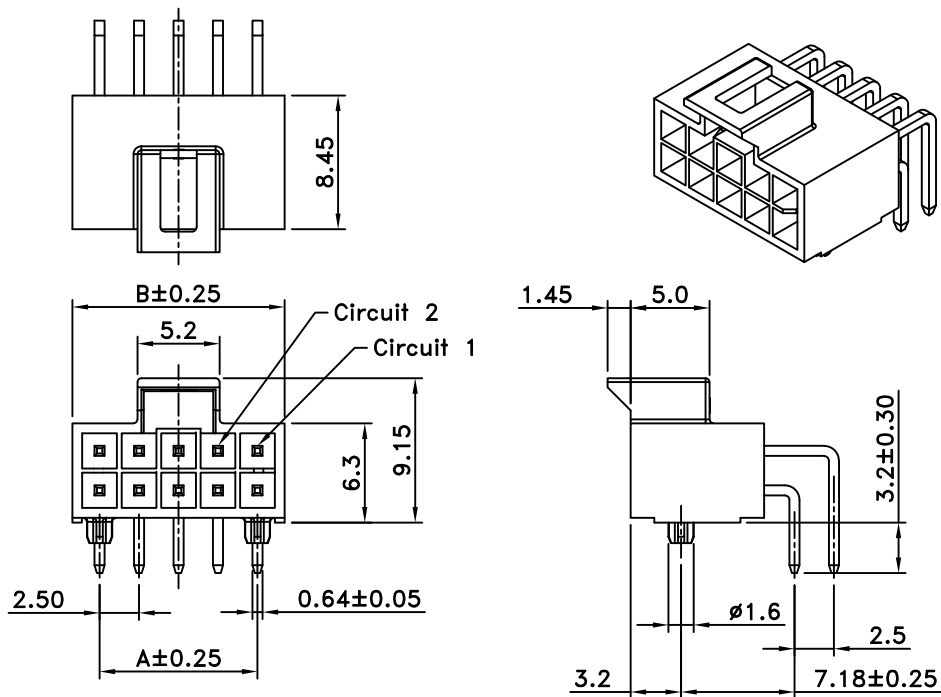

Recommended PCB Layout
General Tolerance ± 0.05

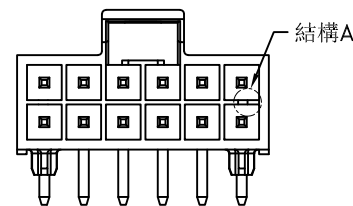

GJS-2513RA-XXx2
Color: Black

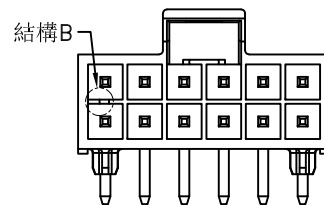

GJS-2513RB-XXx2
Color: Natural

■ SPECIFICATIONS

- Voltage Rating : 250V AC/DC
- Current Rating : 4A AC/DC
- Withstanding Voltage : 1,500V AC/minute
- Insulation Resistance : 1,000M Ω min
- Temperature Range : - 25°C to + 105°C
- Contact Resistance : 30m Ω max.

■ WAFER

- Part No. : GJS-2513RX-XXx2

① ②

① Structure :

- A : 結構A, Color: Black
- B : 結構B, Color: Natural

② Poles : 02x2~08x2

• Material :

- Base : LCP UL94V-0
- Contact : Brass, Tin Plated
- Use With: GJS-2513HX-XXx2 Housing

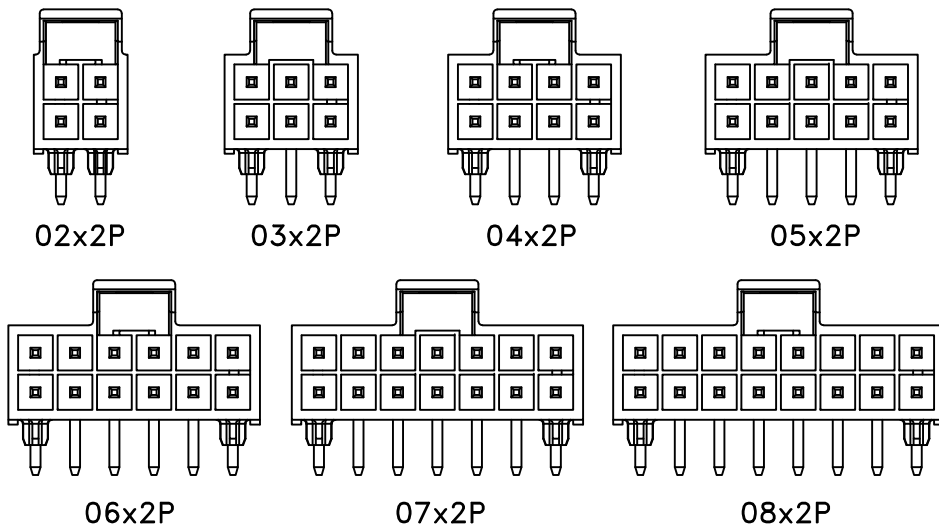

Poles	Dimensions (mm)	
	A	B
02x2	2.50	5.94
03x2	5.00	8.44
04x2	7.50	10.94
05x2	10.00	13.44
06x2	12.50	15.94
07x2	15.00	18.44
08x2	17.50	20.94



东莞乔唯电子有限公司
DONGGUAN CHYAO WEI
ELECTRONIC CO., LTD

APPROVED BY	SCALE	UNIT	TOLERANCE	LTR	REVISION RECORD	NAME	DATE	LTR	REVISION RECORD	NAME	DATE
張育瑞		mm	.0 ±0.30	▲				▲			
CHECKED BY	PROJ	VER NO.	.00 ±0.20	▲				▲			
曾慶根	⊕	a0	.000 ±0.10	▲				▲			
DRAWN BY	DATE	SIZE	ANGLE	▲				▲			
曾慶根	2020/11/16	A4	0° ±1°	▲				▲			
			.0° ±	▲				▲			
			SHEET 1/1	▲				▲			

PART NO GJS-2513RX-XXx2

2.50mm Wire to Board Connectors Wafer

CUSTOMER
Conforms to The RoHS Instruction